

Northeastern University

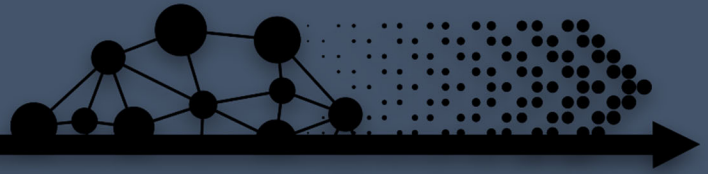

# PREPAREDNESS DAY

**INFORMATION** ✓ **TRAINING** ✓ **EXERCISE**



**Emergency Management**  
*Ready and resilient*

# AGENDA & EVENT INFORMATION 2023

**NORTHEASTERN UNIVERSITY PREPAREDNESS DAY**  
**THURSDAY, OCTOBER 12<sup>TH</sup>, 2023**  
*Curry Student Center*

# Northeastern University | Preparedness Day

---



Preparedness Day at Northeastern University is a series of events that will take place in effort to share information, provide training, and facilitate discussion-based exercises for the purpose of preparedness.

The goal of the event is to provide the participants with the information and the additional capacity to build their condition of preparedness with confidence.

---

## **Event Website:**

For Current Information on the 2023 Preparedness Day visit [\*\*nupd.northeastern.edu/preparedness-day\*\*](https://nupd.northeastern.edu/preparedness-day)

## **Check-In & Registration:**

Opens starting at **10:00 AM** in the Curry Student Center Indoor Quad. Registration and Check-In will be open throughout the event.

### **You will need to check in on-site.**

## **Exhibit Halls & Information Tables:**

Will be located in the Curry Student Center indoor quad and will be available from **10:00 AM – 2:00 PM.**

## **Parking & Transportation:**

Please note that parking is very limited on campus and public transportation is recommended whenever possible. Northeastern University is easily accessible by Orange Line (Ruggles/Mass Ave), Green Line (Northeastern), and Commuter Rail (Ruggles) MBTA. Those that do need to park on campus should use the visitor parking options on campus located at Columbus Garage (795 Columbus Avenue, Boston, MA 02120), Renaissance Park Garage (835 Columbus Avenue, Boston, MA 02120), or Gainsborough Garage (10 Gainsborough Street, Boston, MA 02115). Parking validation coupons will be available from event staff.

## **Food & Refreshments:**

Coffee and Lunch will be available during the day for active, registered participants in the Curry Student Center Indoor Quad.

## **Event Locations:**

Northeastern University's Curry Student Center is located at 346 Huntington Avenue, Boston, MA 02115

From the Columbus Garage, use the Pedestrian Bridge and walk straight. The Curry Student Center is on the left.

# Campus & Event Map



Northeastern University

Campus Map

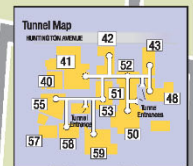

## Academic and Service Buildings

- 66 Alumni Center at Columbus Place (CP)
- 61 Architecture Studio (RG)
- 70 Asian American Center (AC)
- 68 Badger & Rosen SquashBusters Center (SB)
- 40 Barletta Natatorium (BN)
- 26 Behrakis Health Sciences Center (BK)
- 51 Blackman Auditorium (AUDL)
- 41 Cabot Physical Education Center (CB)
- 7 Cahners Hall (CA)
- 36 Cargill Hall (CG)
- 72 Catholic Center (CC)
- 54 Churchill Hall (CH)
- 66 Columbus Place and Alumni Center (CP)
- 47 Cullinane Hall (CN)
- 50 Curry Student Center (CSC)
- 6 Cushing Hall (CU)
- 78 Dana Research Center (DA)
- 39 Dockser Hall (DK)
- 43 Dodge Hall (DG)
- 82 East Village (EV)
- 60 Egan Engineering/ Science Research Center (EC)
- 52 Ell Hall (EL)
- 71 Fenway Center (FC)
- 55 Forsyth Building (FR)
- 78 Hastings Hall at the YMCA (YMC)
- 53 Hayden Hall (HA)
- 10 Hillel-Frager (HF)
- 33 Holmes Hall (HO)
- 46 Hurbig Hall (HT)
- 83 Interdisciplinary Science and Engineering Complex (ISEC) (under construction)
- 77 International Village (INV)
- 35 Kariotis Hall (KA)
- 38 Knowles Center (KN)
- 34 Lake Hall (LA)
- 56 Latino/a Student Cultural Center (LC)
- 17 Marino Recreation Center (MC)
- 44 Matthews Arena (MA)
- 29 Meserve Hall (ME)
- 48 Mugar Life Sciences Building (MU)
- 31 Nightingale Hall (NI)
- 27 O'Bryant African American Institute (AF)
- 63 Renaissance Park (RP)
- 42 Richards Hall (RI)
- 49 Robinson Hall (RB)
- 73 ROTC Office (RO)
- 24 Ryder Hall (RY)
- 30 Shillman Hall (SH)
- 58 Snell Engineering Center (SN)
- 59 Snell Library (SL)
- 37 Stearns Center (ST)
- 23 West Village F, G, H (WV)
- 74 101 Belvidere (BW)
- 80 140 The Fenway (TF)
- 79 177 Huntington (177)
- 81 236 Huntington (236)
- 84 271 Huntington (271)

## Residence Buildings

- 21 Burshtein Hall (BU)
- 67 Davenport Commons A, B (DC)
- 82 East Village (EV)
- 77 International Village (INV)
- 11 Kennedy Hall (KDY)
- 4 Kerr Hall (KH)
- 12 Levine Hall and St. Stephen Street Complex (LV)
- 9 Light Hall (LH)
- 5 Loftman Hall and 153 Hemenway Street (LF)
- 3 Melvin Hall (MH)
- 20 Rubenstein Hall (464)
- 2 Smith Hall (SM)
- 16 Speare Hall (SP)
- 14 Stetson East (SE)
- 15 Stetson West (SW)
- 23C West Village Residence Complex A, B, C, E (WV)
- 23B West Village Residence Complex F, G, H (WV)
- 18 White Hall (WH)
- 28 Willis Hall (WI)
- 69 10 Coventry Street (CV)
- 8 142-148 Hemenway Street (142-148)
- 11 319 Huntington Avenue (319)
- 13 337 Huntington Avenue (337)
- 19 407 Huntington Avenue (407)
- 76 768 Columbus Avenue (768)
- 64 780 Columbus Avenue (780)

## Parking Garages



- 65 Columbus Parking Garage (CPG)
- 75 Belvidere Parking Garage (BVG)
- 45 Gainsborough Parking Garage (GG)
- 62 Renaissance Park Garage (RPG)
- 25 West Village Parking Garage (WPG)

## Legend

- # Academic and Service Buildings
- # Academic/Service Residence Buildings
- # Residence Buildings
- # Parking Garages
- P Parking (permit required)
- V Visitor Parking
- H Handicapped Parking
- Handicapped-Accessible Entrance
- Emergency Telephone
- T MBTA Station
- Star Visitor Center
- Alumni Center at Columbus Place

# Event Agenda

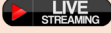
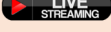
THURSDAY, OCTOBER 12<sup>TH</sup>, 2023

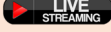
Start	Session (Lead)	Location
10:00	<b>Registration &amp; Check In</b>	Indoor Quad
COFFEE AVAILABLE IN INDOOR QUAD		
10:15	<b>Situational Awareness Training 101</b> Northeastern University Police	333 
	<b>De-Escalation Techniques: Handling Difficult Situations</b> Northeastern University Police	320-322 
11:15	<b>Phishing Preparedness Training</b> Office of Information Security	333 
	<b>Continuity Planning: Preparing and Planning for Your Office and Lab</b> MEMA	318
12:00* Keynote	<b>Drug Threats &amp; Trends</b> Drug Enforcement Administration (DEA)	Ballroom 
LUNCH AVAILABLE FOR KEYNOTE SPEAKER ATTENDEES		
1:15	<b>Active Threat Training</b> Northeastern University Police	320-322 
	<b>Basic Self-Defense Introduction (Hands on Session)</b> Northeastern University Police	Dance Studio



Sessions labeled as Live Streaming will be available via Live Stream link and Recordings following Preparedness Day.

# Interactive Exhibits

<p><b>Northeastern University Police Department</b></p>	<p><i>Learn about the NUPD, meet Cooper &amp; Sarge, and find out about safety resources as well as opportunities to work with the department. Interact with members of the NUPD throughout the event.</i></p>
<p><b>Northeastern University Emergency Management</b></p>	<p><i>Connect with our Office of Emergency Management and learn about the training opportunities and resources available, including the innovative Safety Support Network.</i></p>
<p><b>Northeastern University Police Emergency Communications &amp; Operations</b></p>	<p><i>Learn about the NUPD Emergency Communications &amp; Operations team, the most common scam reports the team receives from the NU community and more.</i></p>
<p><b>Northeastern University Police Wellness</b></p>	<p><i>Wellness at NUPD is an integrated function of the department promoting mental and physical health as well as peer support. Stop by to learn more.</i></p>
<p><b>Drug Enforcement Administration (DEA)</b></p>	<p><i>The DEA will be presenting facts about the latest drug threats and trends in New England, specifically the Boston Region.</i></p>
<p><b>Massachusetts Emergency Management Agency (MEMA)</b></p>	<p><i>Learn about how Massachusetts plans, prepares, and recovers for state-wide emergencies and the resources offered to community members.</i></p>
<p><b>Office of Information Security</b></p>	<p><i>Come test your knowledge of common cyber scams and ways you can protect yourself with Northeastern's Office of Information Security.</i></p>
<p><b>City of Boston Office of Emergency Management</b></p>	<p><i>Learn more about the AlertBoston system and assess your current level of preparedness with the staff from Boston OEM.</i></p>
<p><b>Off Campus Engagement and Support</b></p>	<p><i>Come learn about the red flags and the most common rental scam techniques, leasing agreements &amp; applications, and how to ensure you are working with a proper realty agency.</i></p>
<p><b>SafeZone</b></p>	<p><i>Stop by to learn about the SafeZone application which helps NU community members stay safe on and off campus.</i></p>
<p><b>RAVE</b></p>	<p><i>Learn about the Emergency Notification System that NU uses to communicate during an on-campus emergency.</i></p>

## Interactive Exhibits (Continued...)

<p><b>Boston Fire Department</b></p>	<p>Connect with the city's emergency fire response resources and learn more about their services within the city of Boston. Great for those that live off-campus and travel through the city!</p>
<p><b>FM Global</b></p>	<p>Come learn about fire safety and resiliency services and solutions.</p>
<p><b>Hands Only CPR</b> NUPD CEU</p>	<p>Join one of our officers for a brief tutorial on basic medical information and an interactive hand only CPR station.</p>
<p><b>Digital Fire Simulation</b></p>	<p>Join for an interactive look at Fire Extinguisher use on our new digital simulation station</p>
<p><b>OARS &amp; ECOS Jigsaw</b></p>	<p>"See Something, Say Something": Join OARS &amp; ECOS at Preparedness Day to learn about the available resources.</p>
<p><b>Access Control</b> Residential Safety Office &amp; Husky Card Services</p>	<p>Engaging overview of Northeastern's Residential access control systems. Giveaways, free Husky ID printing, and info on future access control projects. Join the Residential Safety Office and learn more at Prep Day!</p>
<p><b>Northeastern University Global Safety Office</b></p>	<p>Join the NU International Safety Office for an overview of travel safety and the resources available through NU.</p>
<p><b>Operation Lifesaver</b></p>	<p>Learn about the dangers of rail crossings and safety measure to observe when approaching on foot or by vehicle.</p>
<p><b>RISK Services</b></p>	<p>Risk Services identifies, assesses, and mitigates risks which might occur within the University. Learn more about scam prevention &amp; reporting.</p>
<p><b>University Health &amp; Counseling Services (UHCS)</b></p>	<p>Learn about the health and wellness resources offered by the university.</p>
<p><b>Residential Life</b></p>	<p>Promoting safe living habits in the residence halls, including fire safety tips and what to do in the event of a fire or emergency in the residence halls.</p>
<p><b>NU EMS Club</b></p>	<p>Come learn about what goes into a medical emergency response from the NU EMS club.</p>



# Keynote Speaker

## Drug Threats & Trends

Community Outreach Specialist, Brian O'Keefe  
Drug Enforcement Administration | Ballroom

The DEA is dedicated to reducing drug-related violence; and lowering drug overdose deaths. Come listen and learn about how the DEA targets the most dangerous individuals and organizations who are causing harm to our neighborhoods and communities. The drug threats and trends in the New England area, specifically Boston.

Offered at 12:15 PM / Lunch Available starting at 12:00 PM



## Drug Enforcement Agency: New England Division



# Breakout Sessions

## Situational Awareness Training 101

NUPD | CSC 320-322

An overall approach to safety awareness training covering topics such as behavioral recognition, active threat response, fire safety, and reporting criminal activity. Recommended course for all.

## De-Escalation Techniques: Handling Difficult Situations

NUPD | CSC 333

Want to learn more about being prepared to De-escalate a situation at work, or at home? This course expands on the concepts of Security Awareness Training 101. It also includes scenario-based role-playing. The training consists of a brief presentation and then is followed by the breakout scenarios. The entire group is encouraged to participate as actors.

## NUPD Self-Defense Course

NUPD | CSC Dance Studio

Introduction to Basic Self-Defense. Training Participants in Educated Decisions for Resistance and the Fight or Flight Response. First Come First Seated (Seats are Limited). Class is Interactive, Dress Comfortably.

## Phishing Protection Training

OIS | CSC 333

Cybersecurity awareness, a timely and relevant topic, as technology continue to play an increasingly important role in our daily lives. The session will review the various social engineering attacks (such as phishing), some of the tools used by attackers to modernize their scams, and what people should be looking for to prevent becoming a victim.

## Continuity Planning: Preparing and Planning for Your Office and Lab

MEMA | CSC 318

Join our state partner, the Massachusetts Emergency Management Agency, to learn about Continuity Planning for your office and lab spaces.

## Active Threat Training

NUPD | CSC 320-322

Come review how to keep yourself safe when facing an active threat. NUPD will review run, hide, fight, and other safety procedures to keep the NU community safe.



## Participant Raffle

*Use your participant QR code to scan into Preparedness Day and automatically be entered in the conference raffle!*



**TWO CHANCES TO WIN!**

**FOR ADDITIONAL INFORMATION ABOUT PREPAREDNESS DAY AND OTHER EVENTS OFFERED BY THE NU OFFICE OF EMERGENCY MANAGEMENT AND NU POLICE, PLEASE REACH OUT TO:**

Todd C. Kaplan, Ph.D. – Sr. Director, NU Emergency Management – [t.kaplan@northeastern.edu](mailto:t.kaplan@northeastern.edu)  
Amanda McGoldrick – Assistant Director, NU Emergency Management – [a.mcgoldrick@northeastern.edu](mailto:a.mcgoldrick@northeastern.edu)  
Sgt. Joseph Corbett – Crime Prevention and Community Engagement – [j.corbett@northeastern.edu](mailto:j.corbett@northeastern.edu)

# Exhibit Hall

## Preparedness Day 2023

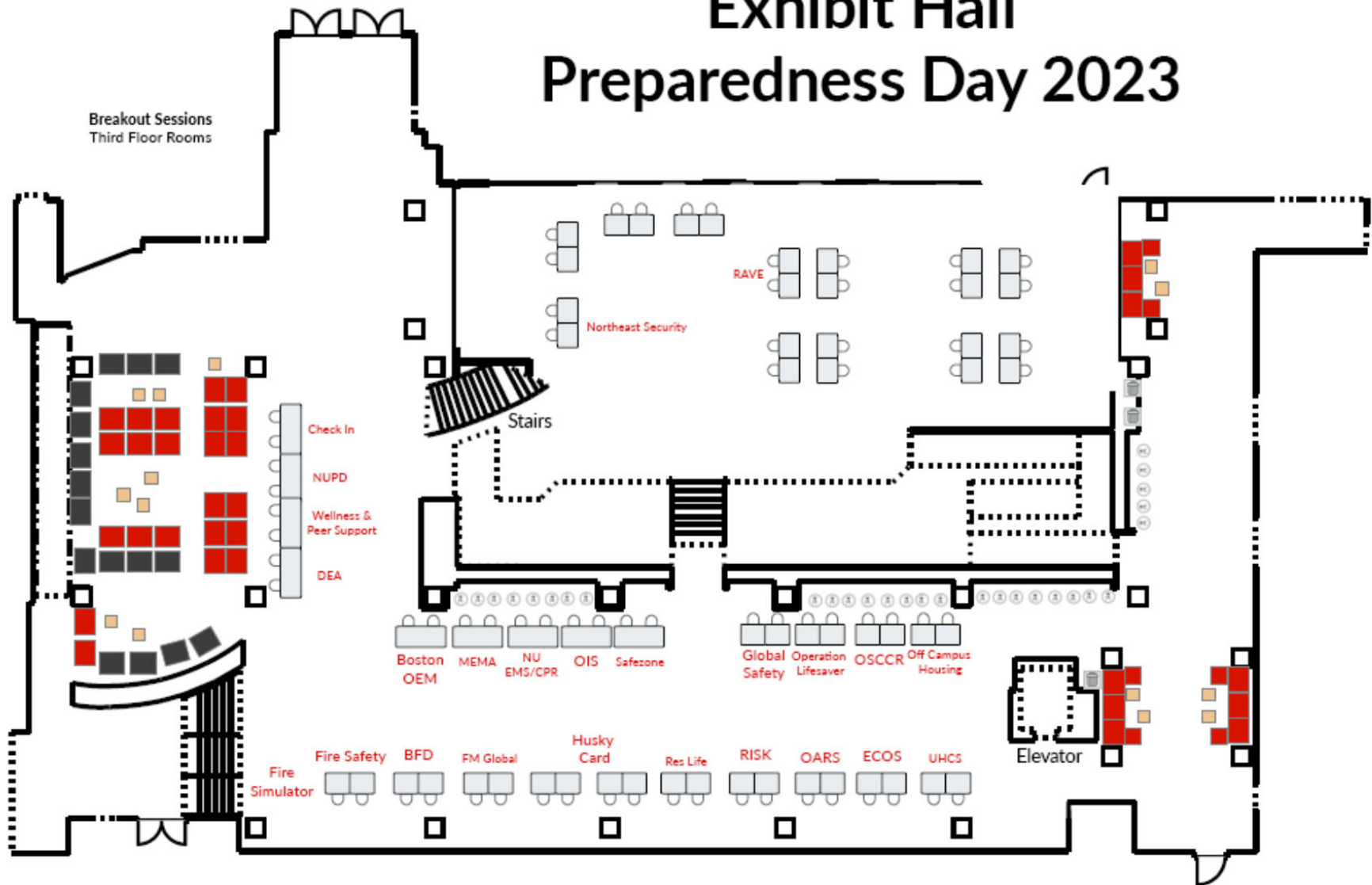

Please Stop by the Check In Desk for Event Information