

Northeastern University

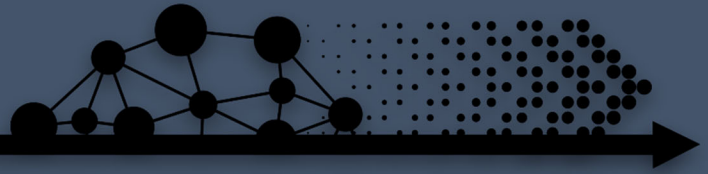

PREPAREDNESS DAY

INFORMATION ✓ **TRAINING** ✓ **EXERCISE**



Emergency Management
Ready and resilient

AGENDA & EVENT INFORMATION OCTOBER 2025

NORTHEASTERN UNIVERSITY PREPAREDNESS DAY
THURSDAY, OCTOBER 16TH, 2025
Curry Student Center

Northeastern University | Preparedness & Scam Prevention Day



Preparedness & Scam Prevention Day at Northeastern University is a series of events that will take place in effort to share information, provide training, and facilitate discussion-based exercises for the purpose of preparedness.

The goal of the event is to provide the participants with the information and the additional capacity to build their condition of preparedness with confidence.

Event Website:

For Current Information on the 2025 Preparedness & Scam Prevention Day visit
nupd.regfox.com/prepday25

Check-In & Registration:

Opens starting at **10:00 AM** in the Curry Student Center Indoor Quad. Registration and Check-In will be open throughout the event.

You will need to check in on-site.

Exhibit Halls & Information Tables:

Will be located in the Curry Student Center indoor quad and will be available from **10:00 AM – 2:00 PM.**

Parking & Transportation:

Please note that parking is very limited on campus and public transportation is recommended whenever possible. Northeastern University is easily accessible by Orange Line (Ruggles/Mass Ave), Green Line (Northeastern), and Commuter Rail (Ruggles) MBTA. Those that do need to park on campus should use the visitor parking options on campus located at Columbus Garage (795 Columbus Avenue, Boston, MA 02120), Renaissance Park Garage (835 Columbus Avenue, Boston, MA 02120), or Gainsborough Garage (10 Gainsborough Street, Boston, MA 02115). Parking validation coupons will be available from event staff.

Refreshments:

Coffee will be available. Lunch will be provided on a first come, first serve basis for participants in the scheduled breakout sessions.

Event Locations:

Northeastern University's Curry Student Center is located at 346 Huntington Avenue, Boston, MA 02115

From the Columbus Garage, use the Pedestrian Bridge and walk straight. The Curry Student Center is on the left.

Campus & Event Map



Northeastern University

Campus Map

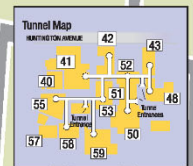

Academic and Service Buildings

- 66 Alumni Center at Columbus Place (CP)
- 61 Architecture Studio (RG)
- 70 Asian American Center (AC)
- 68 Badger & Rosen SquashBusters Center (SB)
- 40 Barletta Natatorium (BN)
- 26 Behrakis Health Sciences Center (BK)
- 51 Blackman Auditorium (AUDL)
- 41 Cabot Physical Education Center (CB)
- 7 Cahners Hall (CA)
- 36 Cargill Hall (CG)
- 72 Catholic Center (CC)
- 54 Churchill Hall (CH)
- 66 Columbus Place and Alumni Center (CP)
- 47 Cullinane Hall (CN)
- 50 Curry Student Center (CSC)
- 6 Cushing Hall (CU)
- 78 Dana Research Center (DA)
- 39 Dockser Hall (DK)
- 43 Dodge Hall (DG)
- 82 East Village (EV)
- 60 Egan Engineering/ Science Research Center (EC)
- 52 Ell Hall (EL)
- 71 Fenway Center (FC)
- 55 Forsyth Building (FR)
- 78 Hastings Hall at the YMCA (YMC)
- 53 Hayden Hall (HA)
- 10 Hillel-Frager (HF)
- 33 Holmes Hall (HO)
- 46 Hurbig Hall (HT)
- 83 Interdisciplinary Science and Engineering Complex (ISEC) (under construction)
- 77 International Village (INV)
- 35 Kariotis Hall (KA)
- 38 Knowles Center (KN)
- 34 Lake Hall (LA)
- 56 Latino/a Student Cultural Center (LC)
- 17 Marino Recreation Center (MC)
- 44 Matthews Arena (MA)
- 29 Meserve Hall (ME)
- 48 Mugar Life Sciences Building (MU)
- 31 Nightingale Hall (NI)
- 27 O'Bryant African American Institute (AF)
- 63 Renaissance Park (RP)
- 42 Richards Hall (RI)
- 49 Robinson Hall (RB)
- 73 ROTC Office (RO)
- 24 Ryder Hall (RY)
- 30 Shillman Hall (SH)
- 58 Snell Engineering Center (SN)
- 59 Snell Library (SL)
- 37 Stearns Center (ST)
- 23 West Village F, G, H (WV)
- 74 101 Belvidere (BW)
- 80 140 The Fenway (TF)
- 79 177 Huntington (177)
- 81 236 Huntington (236)
- 84 271 Huntington (271)

Residence Buildings

- 21 Burshtein Hall (BU)
- 67 Davenport Commons A, B (DC)
- 82 East Village (EV)
- 77 International Village (INV)
- 11 Kennedy Hall (KDY)
- 4 Kerr Hall (KH)
- 12 Levine Hall and St. Stephen Street Complex (LV)
- 9 Light Hall (LH)
- 5 Loftman Hall and 153 Hemenway Street (LF)
- 3 Melvin Hall (MH)
- 20 Rubenstein Hall (464)
- 2 Smith Hall (SM)
- 16 Speare Hall (SP)
- 14 Stetson East (SE)
- 15 Stetson West (SW)
- 23 West Village Residence Complex A, B, C, E (WV)
- 23 West Village Residence Complex F, G, H (WV)
- 18 White Hall (WH)
- 28 Willis Hall (WI)
- 69 10 Coventry Street (CV)
- 8 142-148 Hemenway Street (142-148)
- 11 319 Huntington Avenue (319)
- 13 337 Huntington Avenue (337)
- 19 407 Huntington Avenue (407)
- 76 768 Columbus Avenue (768)
- 64 780 Columbus Avenue (780)

Parking Garages

- 65 Columbus Parking Garage (CPG)
- 76 Belvidere Parking Garage (BVG)
- 45 Gainsborough Parking Garage (GG)
- 62 Renaissance Park Garage (RPG)
- 25 West Village Parking Garage (WPG)

Legend

- # Academic and Service Buildings
- # Academic/Service Residence Buildings
- # Residence Buildings
- # Parking Garages
- P Parking (permit required)
- V Visitor Parking
- H Handicapped Parking
- A Handicapped-Accessible Entrance
- T Emergency Telephone
- M MBTA Station
- S Visitor Center
- A Alumni Center at Columbus Place

Event Agenda

THURSDAY, OCTOBER 16TH, 2025

Start	Session (Lead)	Location
10:00	Registration & Check In	Indoor Quad
COFFEE AVAILABLE IN INDOOR QUAD/PIT NEAR EXHIBITS		
10:00	<u>Supporting Student Mental Health</u> UHCS & OPEN (Staff and Faculty only – sign up is required)	333
10:00	Scam Prevention Northeastern University Police	318-322
11:00	Pet CPR Northeastern University Police	318-322
12:00	K-9 Sarge Demonstration + Stop the Bleed Northeastern University Police	318-322
1:00	Basic Self-Defense Introduction <i>(Hands on Session)</i> Northeastern University Police	318-322

First come, first serve for seats in breakout sessions.

Interactive Exhibits

<p>Northeastern University Police Department</p>	<p>Learn about the NUPD, meet Cooper & Sarge, and find out about safety resources as well as opportunities to work with the department. Interact with members of the NUPD throughout the event.</p>
<p>Northeastern University Emergency Management</p>	<p>Connect with our Office of Emergency Management and learn about the training opportunities and resources available, including the innovative Safety Support Network.</p>
<p>Northeastern University Police Emergency Communications & Operations</p>	<p>Learn about the NUPD Emergency Communications & Operations team, the most common scam reports the team receives from the NU community and more.</p>
<p>Boston Fire Department</p>	<p>Connect with the city's emergency fire response resources and learn more about their services within the city of Boston. Great for those that live off-campus and travel through the city!</p>
<p>NU Emergency Medical Services (NU EMS)</p>	<p>Stop by to hear about the NU EMS Club, review first-aid, and learn about the importance of being CPR certified by learning hands-only CPR.</p>
<p>Off Campus Engagement and Support</p>	<p>Come learn about the red flags and the most common rental scam techniques, leasing agreements & applications, and how to ensure you are working with a proper realty agency.</p>
<p>Fire Safety (NUPD)</p>	<p>Join for an interactive look at Fire Extinguisher use on our digital simulation station.</p>
<p>OARS & ECOS</p>	<p>Join OARS & ECOS at Preparedness Day to learn about the available resources.</p>
<p>Access Control Residential Safety Office & Husky Card Services</p>	<p>Engaging overview of Northeastern Residential access control systems. Giveaways, free Husky ID printing, and info on future access control projects. Join the Residential Safety Office and learn more at Prep Day!</p>
<p>Global Safety Office</p>	<p>Join the NU International Safety Office for an overview of travel safety and the resources available through NU.</p>
<p>Operation Lifesaver</p>	<p>Learn about the dangers of rail crossings and safety measure to observe when approaching on foot or by vehicle.</p>

Interactive Exhibits (Continued...)

UHCS	Stop by to learn about UHCS and the services offered to those within the NU community.
Acute Care NP Program	We will have a display on anaphylaxis and the proper use of EpiPens. Participants will learn to recognize the signs and symptoms of anaphylaxis and how to safely and effectively use an EpiPen.
Office of Information Security	Stop by to learn about how the university prioritizes cybersecurity, and resources in place.
RISK	Providing the campus community with resources, guidance, and training to increase risk awareness and promote personal and campus safety.
Office of Global Services	Supporting international students with immigration advising, cultural resources, and community connections.
Residential Life	Building inclusive on-campus communities through housing, programs, and student support.
<p>FM GLOBAL (Matthews Arena Lot)</p>	<p>FM Global is one of the world's largest commercial property insurers, known for helping organizations build resilience against risks such as fire, flood, and natural hazards. Their Resilience Truck is a mobile, interactive experience designed to showcase cutting-edge loss-prevention science and risk management solutions.</p> <p>During its visit to campus, the Resilience Truck will be parked outside Matthews Arena, giving students, faculty, and staff the chance to step inside, explore hands-on demonstrations, and learn how engineering and innovation help protect businesses and communities around the globe.</p> <p>*Tours are based on sign up*</p>

Breakout Sessions

Supporting Student Mental Health

UHCS & OPEN | CSC 333

This workshop will provide faculty and staff with an opportunity to discuss how mental health is impacting students. Faculty and staff will leave the session with concrete skills on recognizing students in distress, responding to students using motivational interviewing techniques and referring students to appropriate Northeastern resources.

Scam Prevention

NUPD | CSC 318-322

A workshop for college students on recognizing common scams, protecting personal information, and safely navigating online and financial interactions.

Pet CPR

NUPD | CSC 318-322

An introduction to CPR for your four-legged friend. Learn what to do if you find your pet unresponsive, not breathing, and who to call for help.

K-9 Sarge Demo & Stop the Bleed

NUPD | CSC 318-322

A live K-9 demonstration highlighting a bomb detection dog's role in campus safety followed by an interactive session featuring Stop the Bleed training, where participants learn life-saving bleeding control techniques.

NUPD Basic Self-Defense Course

NUPD | CSC 318-322

Introduction to Basic Self-Defense. Training Participants in Educated Decisions for Resistance and the Fight or Flight Response. First Come First Seated (Seats are Limited). Class is Interactive, Dress Comfortably.

Participant Raffle

Participants will have the chance to enter a raffle giveaway. At check-in, you'll receive a stamp card from our partners. Collect all the stamps, return your completed card, and you'll be entered into the giveaway!

FOR ADDITIONAL INFORMATION ABOUT PREPAREDNESS DAY AND OTHER EVENTS OFFERED BY THE NU OFFICE OF EMERGENCY MANAGEMENT AND NU POLICE, PLEASE REACH OUT TO:

Todd C. Kaplan, Ph.D. – Sr. Director, NU Emergency Management – t.kaplan@northeastern.edu

Amanda McGoldrick – Assistant Director, NU Emergency Management – a.mcgoldrick@northeastern.edu

Lt. Allison Piantedosi – Crime Prevention and Community Engagement – a.piantedosi@northeastern.edu

Exhibit Hall

Preparedness & Scam Prevention Day 2025

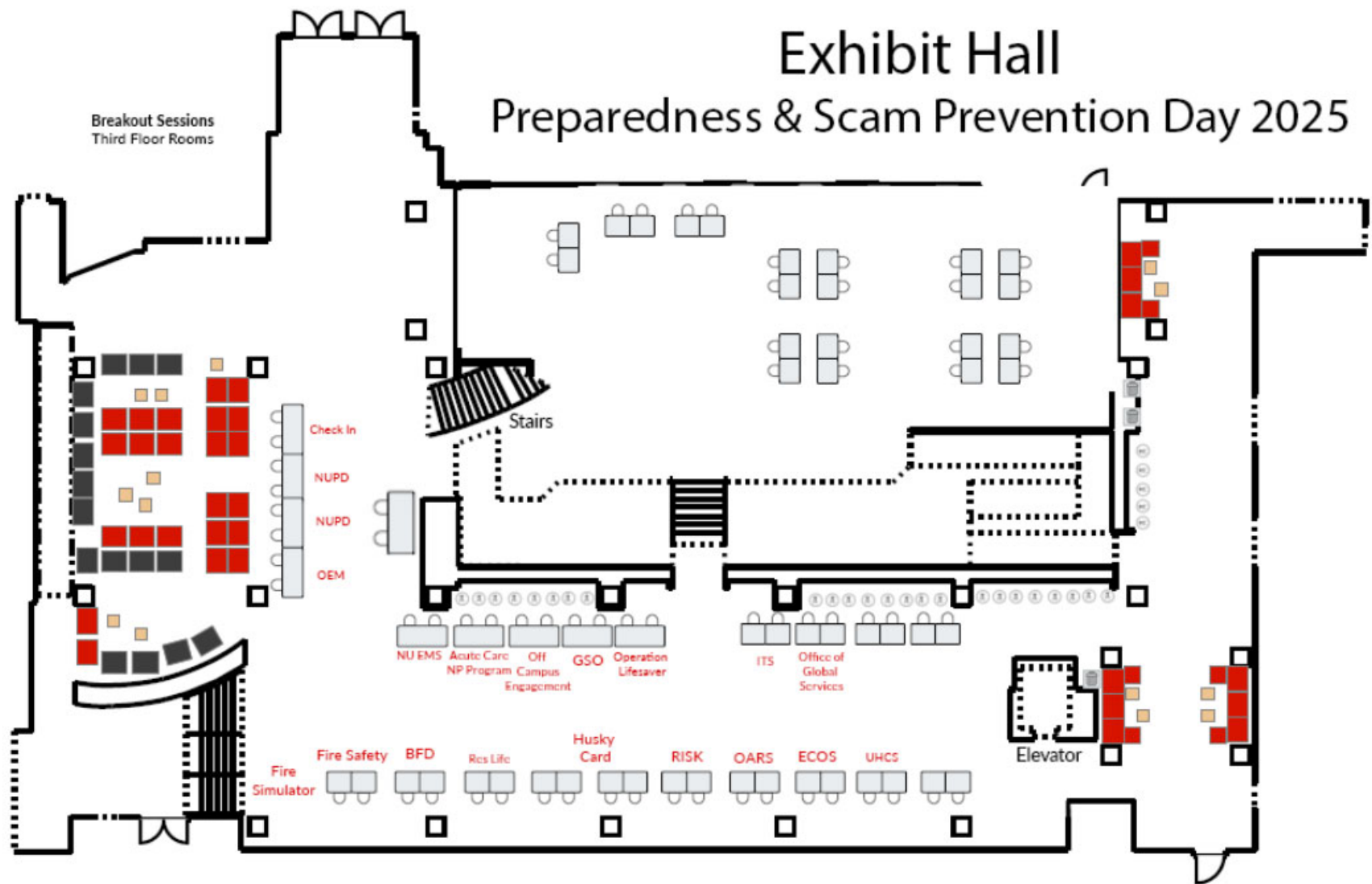

Please Stop by the Check In Desk for Event Information



FM Global is one of the world's largest commercial property insurers, known for helping organizations build resilience against risks such as fire, flood, and natural hazards. Their [Resilience Truck](#) is a mobile, interactive experience designed to showcase cutting-edge loss-prevention science and risk management solutions.

During its visit to campus, the [Resilience Truck](#) will be parked at [Matthews Arena Lot](#), giving students, faculty, and staff the chance to step inside, explore hands-on demonstrations, and learn how engineering and innovation help protect businesses and communities around the globe.

Tours are based on sign up